

## Model:THST6416D

Square hole plug terminal output,sub-plate mount;The faulty wiring can lead to product damage,Please according to direction of arrow to thread when testing DC current,reverse threading will lead to inaccurate output, The output is linear with primary test current,and the output signal can be directly enter automatic control equipment or PLC port.

### Safety indexes:

Flame retardant: consistent with UL94-V0

Working temperature:  $-10^{\circ}\text{C} \sim +70^{\circ}\text{C}$

Storage temperature:  $-40^{\circ}\text{C} \sim +85^{\circ}\text{C}$

Dielectric strength: 2.5KV 50Hz 1min

Overload capacity:8 times

Waterproof level: IP00 (Terminal needs to be sealing treatment of IP44)

### Technical parameter:

Rated input	300~2000	A
Input measure range	$I_p * 120\%$	A
Rated output	0-20; 4-20	mA
	0-5; 1-5; 0-10	V
Accuracy	1	%
Linearity	0.5	%
Supply voltage( $\pm 5\%$ )	+12、+24	V
Current consumption	$38 + I_o$	mA
Load capacity	10V/20mA	
Zero offset TA=25°C	$\leq 0.1\text{mA}$ or $10\text{mV}$	
Response time	<350	ms
Working frequency	DC	Hz
Weight	530	g

### Dimensions:

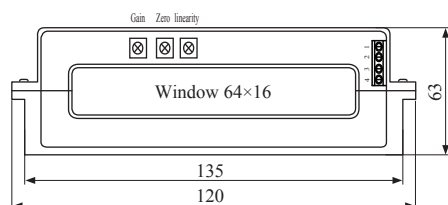

Front view

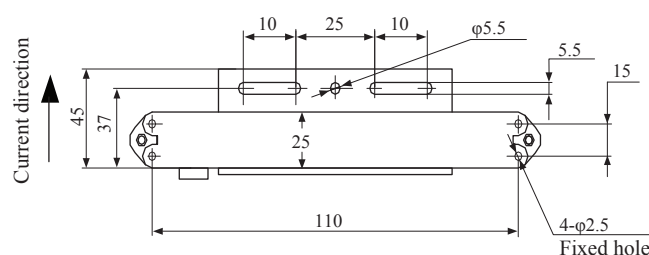

Bottom view



The picture is for reference only

### Connection diagram:

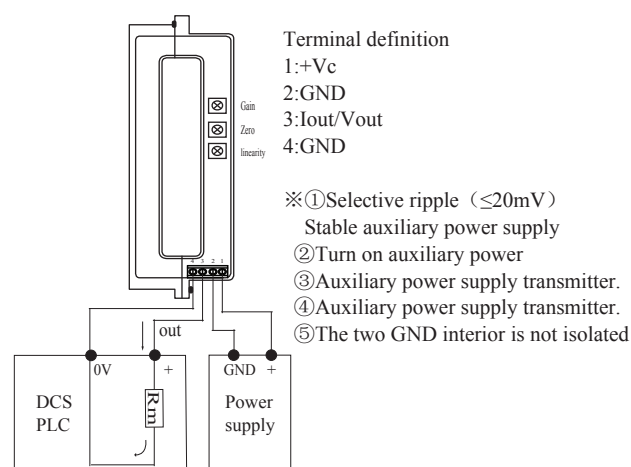

### Plug connect diagram:

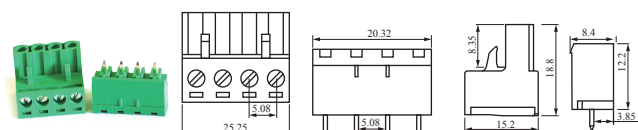

Crimping terminal quick plug,SY2EDGVC-5.08-04P-4 Distance 5.08, Pin size 1×1